



Agronic Injectors

Intended Application

For the application of slurry to crop roots or on growing grassland by means of a shallow-cut groove, with as little damage to the crop or growing surface as possible.

Proven technology that has been in use for over 20 years, that has demonstrated to provide reduced odour and reduced loss of valuable nitrogen.

The application of slurry by means of a spreading ramp also provides a beneficial increase in soil microbes, improved soil structure, increased crop yields, and a reduced risk of slurry run-off in waterways.



AGRONIC Trailing Shoe injectors and Dribble Bar Ramps.



The **AGRONIC trailing shoe injector** makes it possible to spread liquid manure on to grassland during the growing season. The nutrient loss and unwanted odours are kept to a minimum, while the period for spreading liquid manure can be extended. The spring-loaded knives create a 5–40 mm deep incision in the ground at 30-cm intervals, into which the slurry is carefully injected by the nozzle. The trailing shoe works extremely well, even on light soils and on after crop stubble. Thanks to the articulated frame, the trailing shoe ramp accurately follows the tanker through turns, even with crab steering.

Folding for transport is automated, and the ramp is compact in the transport position.

AGRONIC dribble bars are available in two models, with working widths of 12 or 16 m. The dribble bars hoses have an inside diameter of 50-mm, and depending on the working width, there are 40 or 54 hoses, with an inter-hose spacing of 30-cm.

The hoses are equipped with supports ensuring they stay straight during transport and working positions. The hoses consist of three parts, with a closed end design to prevent entanglement.

The hoses are automatically rotated vertically to prevent dripping.



Each individual knife is equipped with suspension. The frame of the spreading ramp can be angled and rotated independently of the slurry tanker.

The angle and rotation are dampened by shock absorbers so that the spreading ramp follows the ground surface closely, and top-quality results are achieved in all conditions. Even on uneven fields with open ruts.

The slurry is dosed in a furrow with 12 mm wide rubber nozzles that follow the soil surface



Technical Specifications

Model	Trailing Shoe			Dribble Bar	
	8 m	12m	15m	12m	16m
Working width:	8 m	12m	15m	12m	16m
Distributor Head:		4 directions			
Number of hoses:	26	40	54	40	54
Oil Flow Requirement min.:			50l/min		
Coulter Spacing:			30 cm.		
Coulter Pressure:		15 kg/insert			
Spreading Plate		Optional equipment			
Hydraulic Stone Trap:		Standard equipment			
Automatic Working Depth Control:		Not required, not available			

AGRONIC AG 8000 - Disc Injector Spreading Ramp



The AGRONIC disc injector follows the ground surface closely, the frame features a center articulation point, allowing the outer sections to follow the contours of the ground surface.

The discs 50cm travel height, allowing them to effectively clear obstacles.

The open frame design, along with a reduced traction requirement, make it possible for the disc injector ramp to be used on ploughed ground.

The optional following harrow can effectively replace a pass with the cultivator.



The cutting blades are manufactured from HARDOX wear plate. The distributor can be rotated in both directions and the knives are reversible. The standard hydraulic stone trap can be easily opened from within the tractor cabin.

Chopping or shredding of the material takes place in two steps. The slurry is directed pass through the chopping device in the upper part of the stone trap before heading to the distribution beam. In addition, it is chopped at the ends of the distribution beam.

AGRONIC disc injector makes it possible to spread slurry during the growing season directly in to growing crops.

The nutrient loss and unwanted odors are kept to a minimum, while the period for spreading liquid manure can be extended.

The disc ramp frame can support up to 40 discs with spring security.

The slurry is applied into the groove cut by the discs at the desired working depth. Since the slurry is not applied unnecessarily deep and the furrow is not made unnecessarily large, the traction requirement is kept minimal.

The disc/nozzle injector combination also works on stubble and in fields with high-grown vegetation

The slurry is pumped from the distributor through hoses with an optimal diameter of 50-mm. The flow rate is high enough so that no sludge collects in the hoses. The hoses have no connections or restrictions that can collect sludge, on the way down to the 12-mm wide rubber nozzles. The rubber nozzles are blockage free in operation thanks to their design and the material from which they manufactured.

The spreading ramp can be angled independently of the tanker, with movements being controlled by dampeners. The outer arms and center frame are equipped with pressure accumulators, **while the entire injector ramp can follow the contours of the ground independently.**



The individually mounted cutting discs have a diameter of 300-mm, are manufactured from **wear-resistant boron steel, and feature conical ball bearings.**

The discs have a thickness of 4-mm, have a cutting angle of 1.5 degrees, providing an opening of 11-mm.

An optional furrow opening disc, which produces a cut of 18-mm can be fitted. Optionally, two additional spacer rings can be fitted.

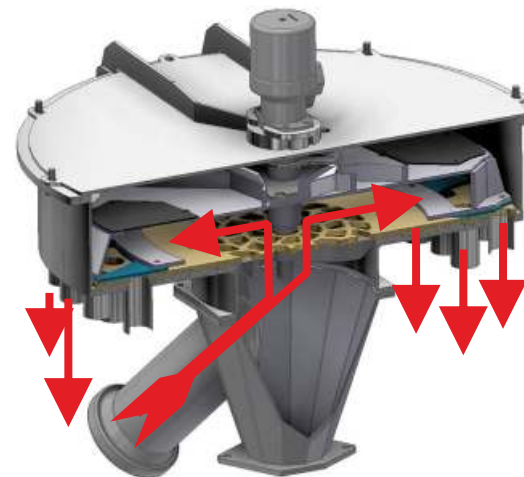

Technical Specifications

Distributor Head:	4-knives
Hoses:	40 or 32* pcs. with a dia. of 50-mm
Oil Requirement:	30 l/min
Working Width:	8.0 m (AG8000) & 6.4 m (AG6000)
Disc Spacing:	20-cm.
Coulter Pressure:	Max. 245 kg/disc
Base Curb Weight:	1850 kg & 1450 kg*
Overload protection:	Accumulators with safety valve. * for a 6.4-m injector

General Information.

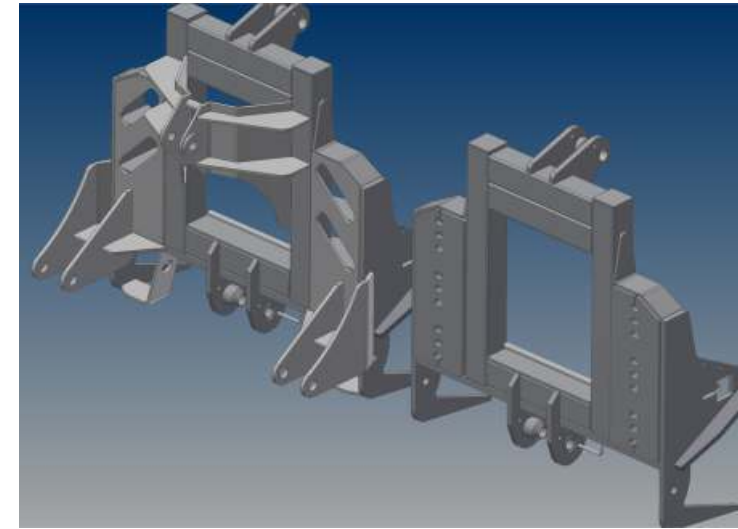

Retrofitting:

Agronic slurry tankers are constructed with mounting points for Agronic ramps. The ramps feature their own lifting equipment. A 3pt linkage lifting system can be installed on the chassis.

Suitable for Use with which Tanker:

Suitable for all Agronic tankers, however the 15,0-m version is not possible with slurry tankers with a capacity of less than 17 m³.

Also, possible to install on other brands of tankers.

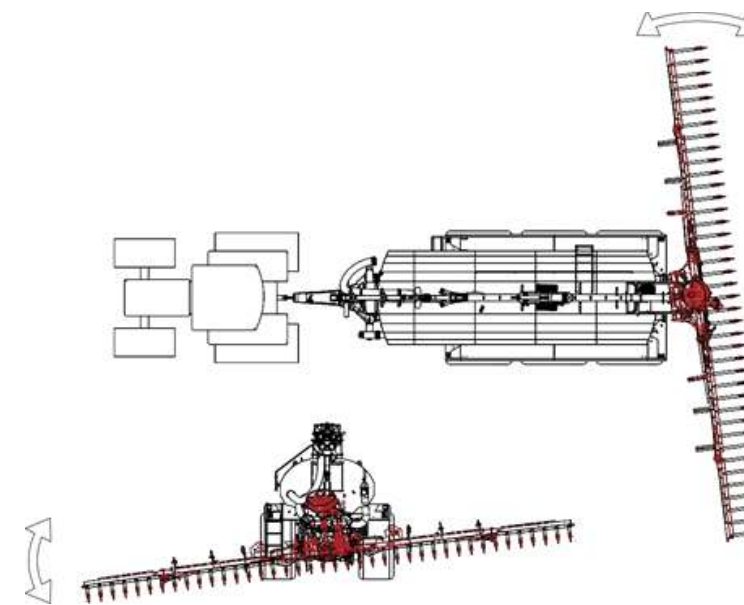

The spreading ramp is not rigid.

All Agronic spreading ramps can swivel and tilt regardless of the position of the slurry tanker.

As a result, Agronic ramps can be used in curves, as well as on slurry tankers equipped with crab steering.

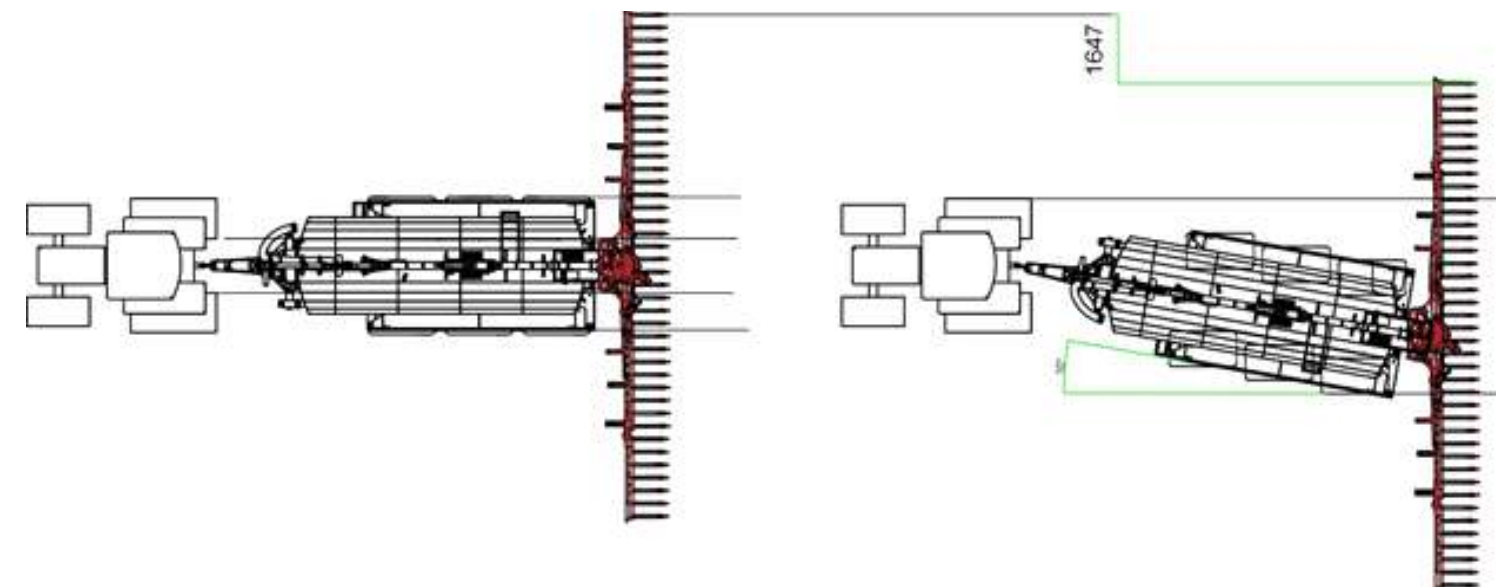

To Find Agronic on YouTube, please click to the link:



AGRONIC[®]
Made in Finland



Agronic Oy
Teollisuustie 5
FI-86600 HAAPAVESI
FINLAND

For More Information:
export@agronic.fi
tel. +358 44 4017 894

www.agronic.fi

We reserve the right to make changes. The products in the pictures have optional equipment.